

FAAM

FHP 12-42

DIMENSIONAL FEATURES

Nominal Voltage	12V	Technology: AGM VRLA Alloy: Pb/Ca Typology of plates: flat Temperature exercise: from -10°C to +50°C Battery sealed no maintenance Safety valves VRLA (a valve per each cell) Box and lid material ABS according UL94:V0 IEC 707 Design life >10-12 years (at 20°C) HP High Performance Standards : IEC CEI EN 60896 Parts 21 and 22
Nominal Capacity (20 hours)	42Ah (Vfin 1,8Vpc at 20°C)	
Dimensions	Length	198 ±2mm
	Width	166 ±2mm
	Box Height	172 ±2mm
	Total Height	172 ±2mm
Drawing n° 400252-0		Weight 14,5 Kg ± 5%
Standard Terminals		Female screw type : M6

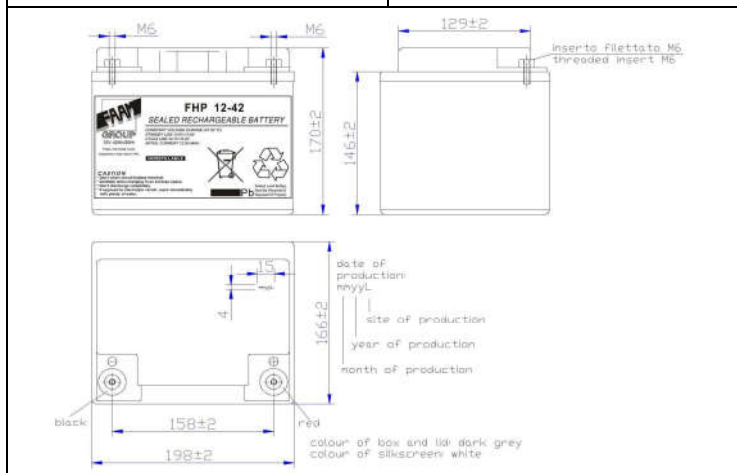

Bolt-and-nut terminal
Bolt Type:M6

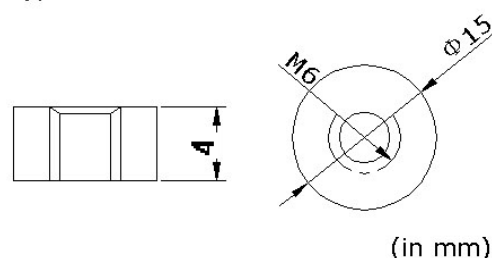

ELECTRIC FEATURES

Characteristics			Discharging curves (20°C)	
Capacity	20 hours (1,8Vfin pc at 20°C)	42,00Ah		
	10 hours (1,8Vfin pc at 20°C)	37,00Ah		
	5 hours (1,7Vfin pc at 20°C)	33,85Ah		
	3 hours (1,7Vfin pc at 20°C)	31,65Ah		
	1 hour (1,6Vfin pc at 20°C)	29,94Ah		
Temperature influence on the capacity	40°C	102%		
	20°C	100%		
	0°C	85%		
Internal Resistance 7 mΩ±10%		SCC 1300 A ±10%		
Constant Charging Voltage	Cyclic use	Initial Charging Current less than 10,5A Voltage 14.70 ~ 15.00V at 20°C Temperature Coefficient -30 mV/°C		
	Stand-by use	No limit on Initial Charging Current Voltage 13.60 ~ 13.80V at 20°C Temperature Coefficient -20 mV/°C		

Discharge Table at constant Current (Amp) and constant Power (Watt/cell) at 20°C

V _{final} /Time		5min	10min	15min	20min	30min	45min	60min	90min	2hours	3hours
9.90V	A	158,17	103,98	78,41	55,21	46,23	34,72	27,81	15,31	14,59	10,95
	W	313,70	212,13	173,63	139,79	97,50	76,73	60,54	43,59	37,00	22,70
10.2V	A	147,36	96,11	73,80	52,43	44,68	32,97	26,62	14,77	14,07	10,55
	W	299,04	202,31	170,87	137,57	94,97	74,74	59,41	42,77	36,31	22,44
10.8V	A	135,19	87,38	65,89	46,40	38,85	29,17	23,77	13,43	13,02	9,95
	W	280,84	189,57	162,27	130,65	90,28	71,04	56,31	40,55	34,42	22,08