

2300931212_AC Connector(3 core,two seals,male)

RoHS

CHANGE NO.	CHANGE CONTENTS	REV.	NAME/DATE
①	Add seal; update Cable O.D; update current; update name	1.0	YFT 2022-8-9

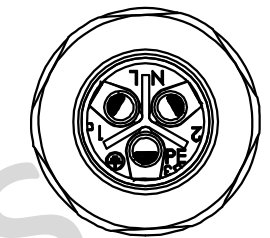
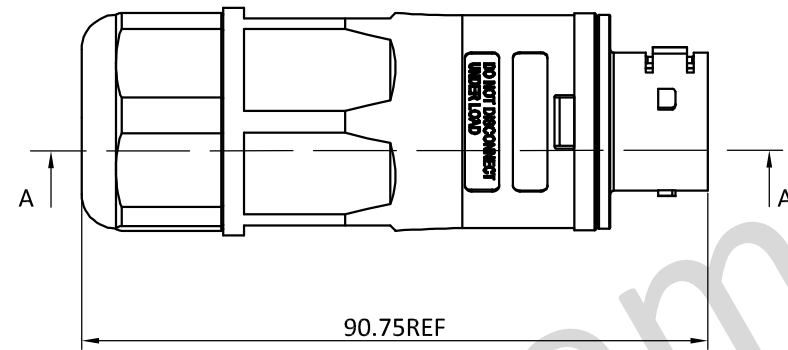
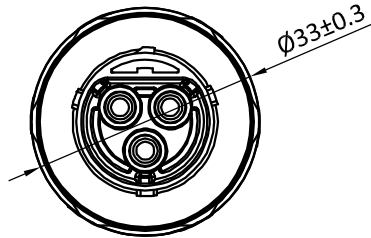

Single-phase connect to L/N/PE
Three-phase connect to 1/2/3

A-A
1:1

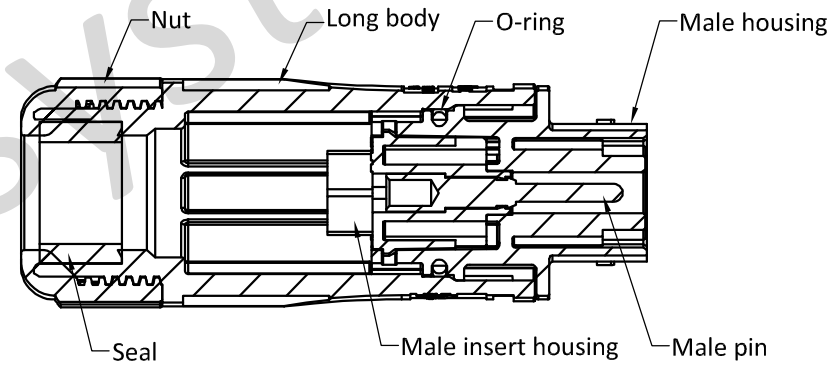

Notes:

Electrical

1. Rated Voltage: 250V AC;
2. Rated Impulse Voltage: 4000V;
3. Rated Current: CSA 32A, TUV 35A;
4. Contact Resistance: ≤5mΩ;
5. Insulation Resistance: ≥500MΩ;

Mechanical:

1. Mating Cycle: ≥500;
2. Cable Retention Force: ≥120N;
3. Pin Retention Force: ≥80N;
4. Cable O.D: 10~15mm;
5. Wire Size: ≤6.0mm²(10AWG);

Environmental:

1. Waterproof Rate: IP68 1m24H;
2. Application Temperature: -40°C~+105°C;
3. Flaming Level: UL94-V0;

Material:

1. Plastic Material: PC&PBT(f1)
2. Pin Material: Copper Alloy, Silver Plating;
3. Sealing Material: Silicone Rubber;
4. Screw Material: SUS, Torque 0.8N.m

Others:

1. Type No.: EN034-2103-101;
2. Packaging: Blank Cartons

- ① Two seals
Seal inner diameter φ17 (black)
For cable size : 4mm² or 10AWG
- Seal inner diameter φ13 (grey)
For cable size : 2.5mm² or 12AWG

TOLERANCES UNLESS OTHERWISE SPECIFIED		MATERIAL		 ALTERNATE ENERGY POWER
X.: ±0.20	X°: ±2.00°			
.X: ±0.10	.X°: ±1.00°			
.XX: ±0.05	.XX°: ±0.50°			
.XXX: ±0.03	.XXX°: ±0.30°			
DWN.	UNIT mm		NAME AC Connector (3 core,two seals,male)	
CHK.	SHEET -- OF --	REV. 1.0	DRAWING NO. -	